



# SALADO ISD

## DISTRIBUTED ANTENNA SYSTEM (DAS)

### EMERGENCY RESPONDER RADIO COVERAGE NETWORKS

**TRUENORTH**  
13284 Pond Spring Road, Suite 304  
Austin, TX 78729  
ph: 512.451.5445 fax: 512.451.8777  
www.truenorth.com



No.	Description	Date
1	DAS SURVEY	05/08/24

Project number 24-0312  
Date 06/13/24  
Drawn by RIG Author  
Checked by Checker

**TITLE**

Scale NTS

**ENLARGEMENT KEYNOTES**

① SPACE RESERVED FOR PUBLIC SAFETY DAS EQUIPMENT.

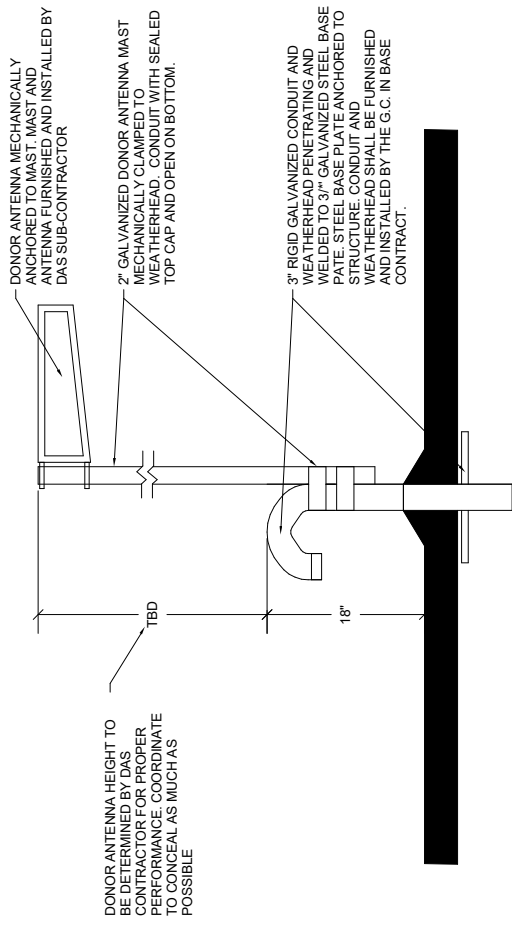

**1** WEATHERHEAD DAS DONOR ANTENNA DETAIL  
SCALE: NTS

**GENERAL NOTES:**

1. INTERFACE WITH FIRE ALARM CONTROL PANEL TO DISPLAY THE CURRENT CONDITION OF THE FOLLOWING AT THE ANNUNCIATOR PANEL AND THE REMOTE ANNUNCIATOR :
  - A. NORMAL AC POWER
  - B. LOSS OF PRIMARY AC POWER
  - C. BATTERY CHARGER MALFUNCTION
  - D. LOW BATTERY (ILLUMINATES AT 30%)
  - E. DONOR ANTENNA MALFUNCTION
  - F. ACTIVE RF EMITTER DEVICE MALFUNCTION
  - G. SYSTEM COMPONENT MALFUNCTION
2. COORDINATE WITH GENERAL CONTRACTOR TO ENSURE SAFETY "LOCKOUT, TAGOUT" BREAKER FEEDING DAS/BDA EQUIPMENT HAS BEEN INSTALLED IN ELECTRICAL PANEL.
3. EMERGENCY POWER OFF. THE UNINTERRUPTIBLE POWER SUPPLY SHALL BE EQUIPPED WITH AN EMERGENCY POWER OFF (EPO) SWITCH LOCATED AT THE FACP (OR OTHER LOCATION AS DETERMINED BY THE LOCAL AUTHORITY HAVING JURISDICTION. THE EPO SHALL IMMEDIATELY DISCONNECT THE PRIMARY AND SECONDARY POWER TO THE DAS.
4. ENSURE THAT DISTRIBUTED ANTENNA SYSTEM ANNUNCIATOR PANEL AND REMOTE ANNUNCIATOR PANEL ARE MOUNTED ADJACENT TO FACP ANNUNCIATOR AND FACP REMOTE ANNUNCIATOR PANELS.
5. ALL SYSTEM COMPONENTS SHALL BE CONTAINED WITHIN NEMA-4 TYPE WATERPROOF CABINETS.
6. BATTERY SYSTEMS SHALL BE CONTAINED IN NEMA-3R OR HIGHER-RATED CABINET(S).
7. EQUIPMENT SHALL HAVE FCC LICENSE CERTIFICATE AND BE SUITABLE FOR PUBLIC SAFETY USE.
8. WHERE A DONOR ANTENNA EXISTS, ISOLATION SHALL BE MAINTAINED BETWEEN THE DONOR ANTENNA AND THE AND ALL INSIDE ANTENNAS TO NOT LESS THAN 20dDb GREATER THAN THE SYSTEM GAIN UNDER ALL OPERATING CONDITIONS.
9. BI-DIRECTIONAL AMPLIFIERS (BDAS) USED IN EMERGENCY RESPONDER RADIO COVERAGE SYSTEMS SHALL HAVE OSCILLATION PREVENTION CIRCUITRY.
10. THE INSTALLATION OF AMPLIFICATION SYSTEMS OR SYSTEMS THAT OPERATION ON OR PROVIDE THE MEANS TO CAUSE INTERFERENCE ON ANY EMERGENCY RESPONDER RADIO COVERAGE NETWORKS SHALL BE COORDINATED AND APPROVED BY THE LOCAL AUTHORITY HAVING JURISDICTION.

**TRUENORTH**  
 13284 Pond Spring Road, Suite 304  
 Austin, TX 78729  
 ph:512.451.5445 fax: 512.451.8777  
 www.truenorth.com



No.	Description	Date
1	DAS SURVEY	05/08/24

Project number	24-0312
Date	06/13/24
Drawn by	RIG Author
Checked by	Checker
Scale	NTS

**TS-0**

**THOMAS ARNOLD  
ELEMENTARY SCHOOL**



TAE-1

Pre-K-K-1st Grade Building

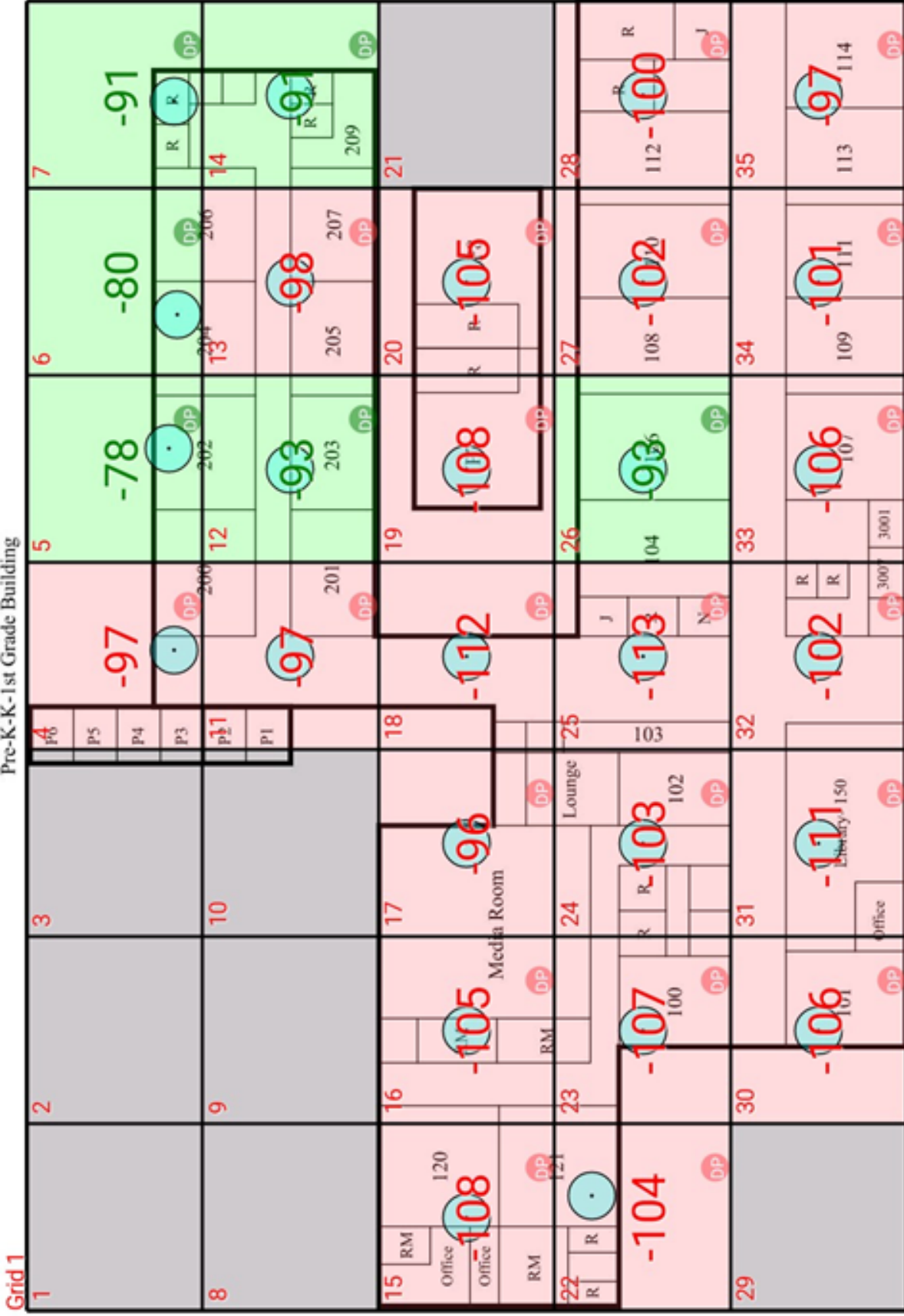

**Test Report Summary**

Channel/ Ch Group	Freq (MHz)	Technology	Band	Result	Area Points passed (%)	Critical Points passed (%)
4	859.23750	P25	Bell County P25	Fail	6/27 (22%)	0/0 (0%)

**Test Report Summary**

**Test Details**

Number of Floors Tested: 1  
 Number of Areas Tested: 27  
 Number of Critical Points Tested: 0

Result Calculation:  
 Area Pass Criteria: 95%  
 Critical Points Pass Criteria: 99%  
 Apply Adjacent Area Rule: No

By area per floor:  
 95%  
 99%  
 No

Grid	# of Areas	Area Size (sq. ft)	Area Width (ft)	Area Height (ft)	Ignore Area Color	Comments
1	35	434.58	21.48	20.23	Black	

**Area Report**

Grid	Area	DL Power (dBm)	DL DAQ	UL Power (dBm)	UL DAQ	DL Loss (dB)	Comment
1	1	NT	NT	NT	NT	NT	
1	2	NT	NT	NT	NT	NT	
1	3	NT	NT	NT	NT	NT	
1	4	-96.65	NT	NT	NT	Fail	
1	5	-77.03	NT	NT	NT	Pass	
1	6	-79.70	NT	NT	NT	Pass	
1	7	-90.59	NT	NT	NT	Pass	
1	8	NT	NT	NT	NT	NT	
1	9	NT	NT	NT	NT	NT	
1	10	NT	NT	NT	NT	NT	
1	11	-96.41	NT	NT	NT	Fail	
1	12	-92.11	NT	NT	NT	Pass	
1	13	-97.68	NT	NT	NT	Fail	
1	14	-90.57	NT	NT	NT	Pass	
1	15	-107.05	NT	NT	NT	Fail	
1	16	-104.41	NT	NT	NT	Fail	
1	17	-95.46	NT	NT	NT	Fail	
1	18	-111.92	NT	NT	NT	Fail	
1	19	-107.11	NT	NT	NT	Fail	
1	20	-104.58	NT	NT	NT	Fail	
1	21	NT	NT	NT	NT	NT	
1	22	-103.51	NT	NT	NT	Fail	
1	23	-106.12	NT	NT	NT	Fail	
1	24	-102.63	NT	NT	NT	Fail	
1	25	-112.24	NT	NT	NT	Fail	
1	26	-92.55	NT	NT	NT	Pass	
1	27	-101.24	NT	NT	NT	Fail	
1	28	-99.85	NT	NT	NT	Fail	
1	29	NT	NT	NT	NT	NT	
1	30	-105.08	NT	NT	NT	Fail	
1	31	-110.85	NT	NT	NT	Fail	
1	32	-101.89	NT	NT	NT	Fail	
1	33	-105.68	NT	NT	NT	Fail	
1	34	-100.03	NT	NT	NT	Fail	
1	35	-96.87	NT	NT	NT	Fail	



13284 Pond Spring Road, Suite 304  
 Austin, TX 78729  
 ph:512.451.5445 fax:512.451.8777  
 www.tmg.com



**THOMAS ARNOLD  
ELEMENTARY SCHOOL**

575 Salado School Rd,  
 Salado, TX 76571

No.	Description	Date
1	DAS SURVEY	05/08/24

TAE -1 - DAS SURVEY RESULTS	
Project number	24-0312
Date	06/13/24
Drawn by	RIG Author
Checked by	Checker
Scale	NTS

**TS-1**

Freq (MHz)	Tech	Band	Ant Gain	Cable Loss	Ph.	Type	Mod	NAC	Area Points passed (%)	Critical Points passed (%)
859.23750	P25	Bell County with Troy	0.00	0.00					12/40 (30%)	2/3 (66%)

Test Details	
Number of Floors Tested:	1 Result Calculation: By area per floor
Number of Areas Tested:	40 Area Pass Criteria: 95%
Number of Critical Points Tested:	3 Critical Points Pass Criteria: 99%
	Apply Adjacent Area Rule: No

Grid	# of Areas	Area Size (sq. ft)	Area Width (ft)	Area Height (ft)	Ignore Area Color	Comments
1	50	266.18	12.63	21.08	Black	

Critical Point Report				
Critical Point	DL Power (dBm)	UL Power (dBm)	DL Loss (dB)	Comment
1	-93.01		Pass	
2	-91.33		Pass	
3	-101.89		Fail	

Area Report				
Grid Area	DL Power (dBm)	UL Power (dBm)	DL Loss (dB)	Comment
1	-97.50		Fail	
2	-100.02		Fail	
3	-98.72		Fail	
4	NT	NT	NT	
5	NT	NT	NT	
6	NT	NT	NT	
7	NT	NT	NT	
8	-87.86		Pass	
9	-97.35		Fail	
10	-99.45		Fail	
11	-96.51		Fail	
12	-99.11		Fail	
13	-98.47		Fail	
14	NT	NT	NT	
15	NT	NT	NT	
16	NT	NT	NT	
17	NT	NT	NT	
18	-104.71		Fail	
19	-101.29		Fail	
20	-98.18		Fail	
21	-101.39		Fail	
22	-103.29		Fail	
23	-99.01		Fail	
24	NT	NT	NT	
25	-91.67		Pass	
26	-91.34		Pass	
27	NT	NT	NT	
28	-97.82		Fail	
29	-99.07		Fail	
30	-103.81		Fail	
31	-89.88		Pass	
32	-99.70		Fail	
33	-95.27		Fail	
34	-96.54		Fail	
35	-93.06		Pass	
36	-95.30		Fail	
37	-93.80		Pass	
38	-99.72		Fail	
39	-96.08		Fail	
40	-95.97		Fail	
41	-90.89		Pass	
42	-95.93		Fail	
43	-87.79		Pass	
44	-87.28		Pass	
45	-86.50		Pass	
46	-99.64		Fail	
47	-94.41		Pass	
48	-97.49		Fail	
49	-97.89		Fail	
50	-93.49		Pass	

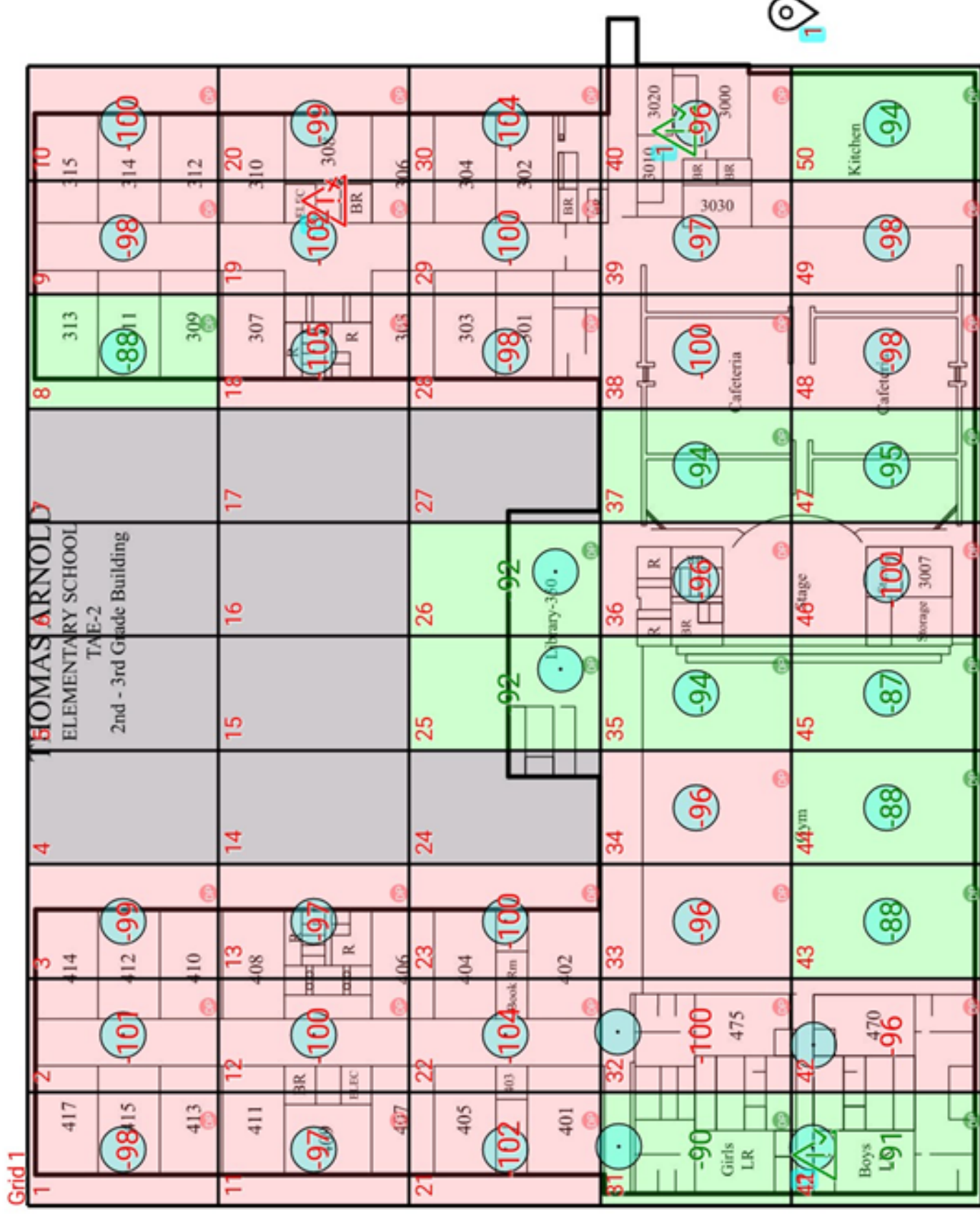

No.	Description	Date
1	DAS SURVEY	05/08/24

  
**THOMAS ARNOLD**  
**ELEMENTARY SCHOOL**  
 575 Salado School Rd,  
 Salado, TX 76571

**TRUENORTH**  
 13284 Pond Spring Road, Suite 304  
 Austin, TX 78729  
 ph: 512.451.5445 fax: 512.451.8777  
 www.truenorth.com

**TAE-2 - DAS SURVEY RESULTS**  
 Project number 24-0312  
 Date 06/13/24  
 Drawn by RIG Author  
 Checked by Checker  
 Scale NTS

**TS-2**

**THOMAS ARNOLD  
ELEMENTARY SCHOOL**  
TAE-3  
4th - 5th Grade Building

Freq (MHz)	Tech	Band	Ant Gain	Cable Loss	Ph. Loss	Type	Mod	NAC	Area Points passed (%)	Critical Point: passed (%)
859.23750	P25	Bell County with Troy	0.00	0.00	0.00				13/30 (43%)	0/0 (0%)

Test Details	
Number of Floors Tested:	1
Number of Areas Tested:	30
Number of Critical Points Tested:	0
Result Calculation:	By area per floor
Area Pass Criteria:	95%
Critical Points Pass Criteria:	99%
Apply Adjacent Area Rule:	No

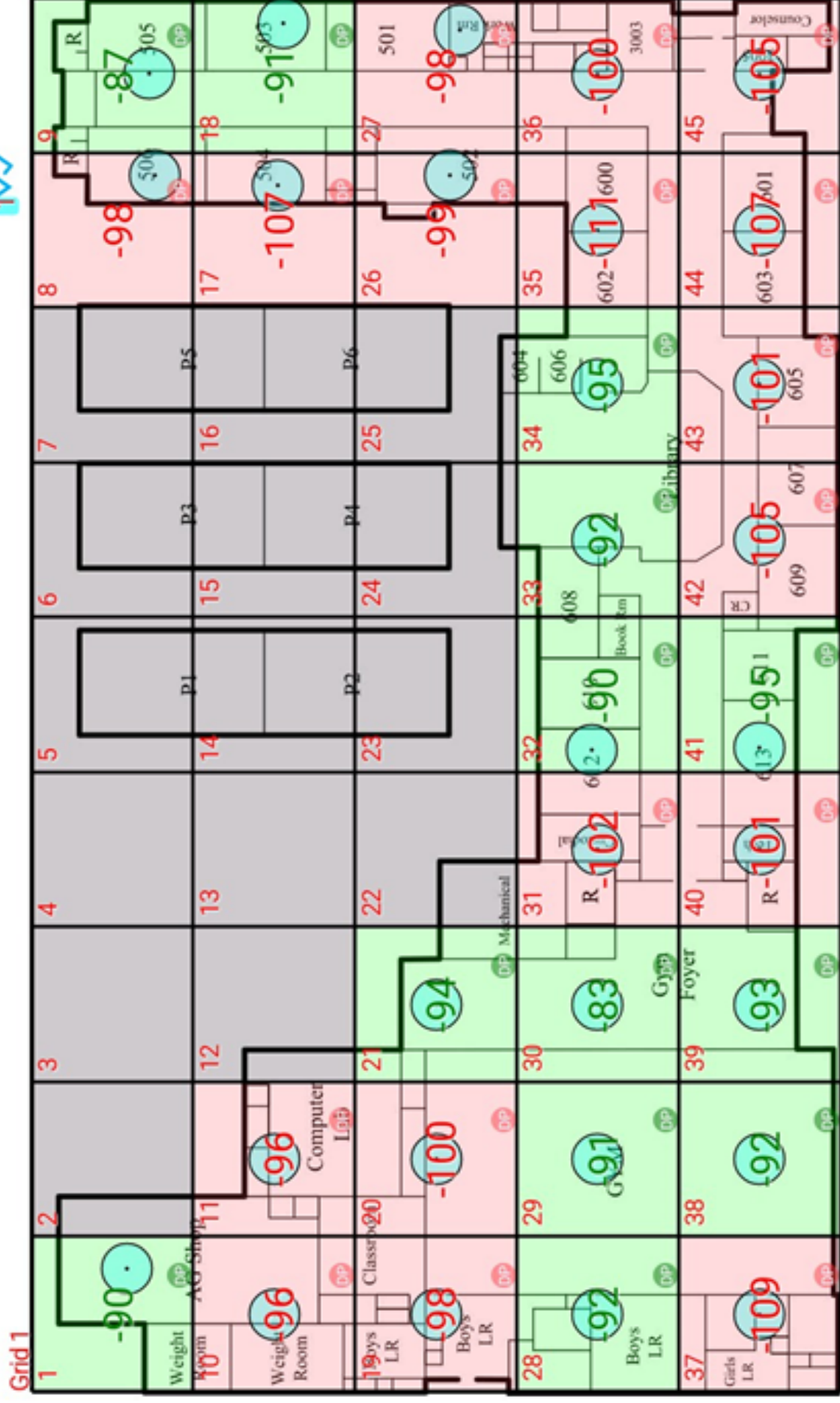

Grid	# of Areas	Area Size (sq. ft)	Area Width (ft)	Area Height (ft)	Ignore Area Color	Comments
1	45	248.46	15.52	16.01	Black	

Grid   Area	DL Power (dBm)	DL DAQ	UL Power (dBm)	UL DAQ	UL Result	DL Loss (dB)	Comment
1   1	-89.95	NT	NT	NT	Pass		
1   2	-98	NT	NT	NT	NT		
1   3	-98	NT	NT	NT	NT		
1   4	-98	NT	NT	NT	NT		
1   5	-98	NT	NT	NT	NT		
1   6	-98	NT	NT	NT	NT		
1   7	-98	NT	NT	NT	NT		
1   8	-97.78	NT	NT	NT	Fail		
1   9	-96.35	NT	NT	NT	Pass		
1   10	-95.91	NT	NT	NT	Fail		
1   11	-95.70	NT	NT	NT	Fail		
1   12	-98	NT	NT	NT	NT		
1   13	-98	NT	NT	NT	NT		
1   14	-98	NT	NT	NT	NT		
1   15	-98	NT	NT	NT	NT		
1   16	-98	NT	NT	NT	NT		
1   17	-106.43	NT	NT	NT	Fail		
1   18	-90.82	NT	NT	NT	Pass		
1   19	-97.30	NT	NT	NT	Fail		
1   20	-99.01	NT	NT	NT	Fail		
1   21	-93.81	NT	NT	NT	Pass		
1   22	-98	NT	NT	NT	NT		
1   23	-98	NT	NT	NT	NT		
1   24	-98	NT	NT	NT	NT		
1   25	-98	NT	NT	NT	NT		
1   26	-98.50	NT	NT	NT	Fail		
1   27	-97.90	NT	NT	NT	Fail		
1   28	-91.13	NT	NT	NT	Pass		
1   29	-90.85	NT	NT	NT	Pass		
1   30	-92.55	NT	NT	NT	Pass		
1   31	-101.96	NT	NT	NT	Fail		
1   32	-80.00	NT	NT	NT	Pass		
1   33	-91.75	NT	NT	NT	Pass		
1   34	-94.35	NT	NT	NT	Pass		
1   35	-110.42	NT	NT	NT	Fail		
1   36	-99.75	NT	NT	NT	Fail		
1   37	-108.40	NT	NT	NT	Fail		
1   38	-91.42	NT	NT	NT	Pass		
1   39	-92.25	NT	NT	NT	Pass		
1   40	-100.53	NT	NT	NT	Fail		
1   41	-94.84	NT	NT	NT	Pass		
1   42	-104.85	NT	NT	NT	Fail		
1   43	-100.12	NT	NT	NT	Fail		
1   44	-106.62	NT	NT	NT	Fail		
1   45	-104.94	NT	NT	NT	Fail		

**TRUENORTH**  
13284 Pond Spring Road, Suite 304  
Austin, TX 78729  
ph: 512.451.5445 fax: 512.451.8777  
www.truenorth.com



**THOMAS ARNOLD  
ELEMENTARY SCHOOL**  
575 Salado School Rd,  
Salado, TX 76571

No.	Description	Date
1	DAS SURVEY	05/08/24

<b>TAE - 3 - DAS SURVEY RESULTS</b>	
Project number	24-0312
Date	06/13/24
Drawn by	RIG Author
Checked by	Checker
Scale	NTS
<b>TS-3</b>	

# Salado Middle School

## First Floor



Freq (MHz)	Tech	Band	Airt Gain	Cable Loss	Ph. Type	Mod	NAC	Area Points passed (%)	Critical Points passed (%)
859.23750	P25	Bell County with Troy	0.00	0.00				344 (6%)	02 (0%)

Test Details	
Number of Floors Tested:	1
Number of Areas Tested:	44
Number of Critical Points Tested:	2

Grid	# of Areas	Area Size (sq. ft)	Area Width (ft)	Area Height (ft)	Ignore Area Color	Comments
1	20	1202.94	30.20	39.83	Black	
2	35	1147.47	41.48	27.67	Black	

Critical Point Report			
Critical Point	DL Power (dBm)	UL Power (dBm)	DL Loss (dB)
1	-110.77		Fail
2	-116.52		Fail

Area Report			
Grid Area	DL Power (dBm)	UL Power (dBm)	DL Loss (dB)
1	NT	NT	NT
2	-98.74	NT	Fail
3	-97.76	NT	Fail
4	-82.25	NT	Pass
5	-112.08	NT	Fail
6	-97.21	NT	Fail
7	-110.76	NT	Fail
8	-109.49	NT	Fail
9	-108.40	NT	Fail
10	-105.31	NT	Fail
11	-103.88	NT	Fail
12	-108.90	NT	Fail
13	-108.80	NT	Fail
14	-111.39	NT	Fail
15	-115.19	NT	Fail
16	-103.77	NT	Fail
17	-118.58	NT	Fail
18	-124.84	NT	Fail
19	-103.08	NT	Fail
20	-100.80	NT	Fail
21	-101.07	NT	Fail
22	-98.95	NT	Fail
23	-78.13	NT	Pass
24	NT	NT	NT
25	NT	NT	NT
26	NT	NT	NT
27	NT	NT	NT
28	-98.92	NT	Fail
29	-97.10	NT	Fail
30	-108.19	NT	Fail
31	-96.01	NT	Fail
32	-102.33	NT	Fail
33	-96.03	NT	Fail
34	-108.75	NT	Fail
35	NT	NT	NT
36	-104.03	NT	Fail
37	-108.57	NT	Fail
38	-105.85	NT	Fail
39	-104.48	NT	Fail
40	-108.72	NT	Fail
41	-108.76	NT	Fail
42	-112.74	NT	Fail
43	-101.39	NT	Fail
44	-109.50	NT	Fail
45	-107.20	NT	Fail
46	-93.53	NT	Pass
47	NT	NT	NT
48	NT	NT	NT
49	NT	NT	NT
50	-114.83	NT	Fail
51	-107.28	NT	Fail
52	-110.18	NT	Fail
53	-99.25	NT	Fail
54	NT	NT	NT

**TRUENORTH**  
 13284 Pond Spring Road, Suite 304  
 Austin, TX 78729  
 ph:512.451.5445 fax:512.451.8777  
 www.tmg.com



**SALADO MIDDLE SCHOOL**  
 1169 Williams Rd,  
 Salado, TX 76571

No.	Description	Date
1	DAS SURVEY	05/08/24

**SALADO MS - DAS SURVEY RESULTS**

Project number 24-0312  
 Date 06/13/24  
 Drawn by RIG Author  
 Checked by Checker  
 Scale NTS

**TS-4**

# Salado Middle

## School Second Floor

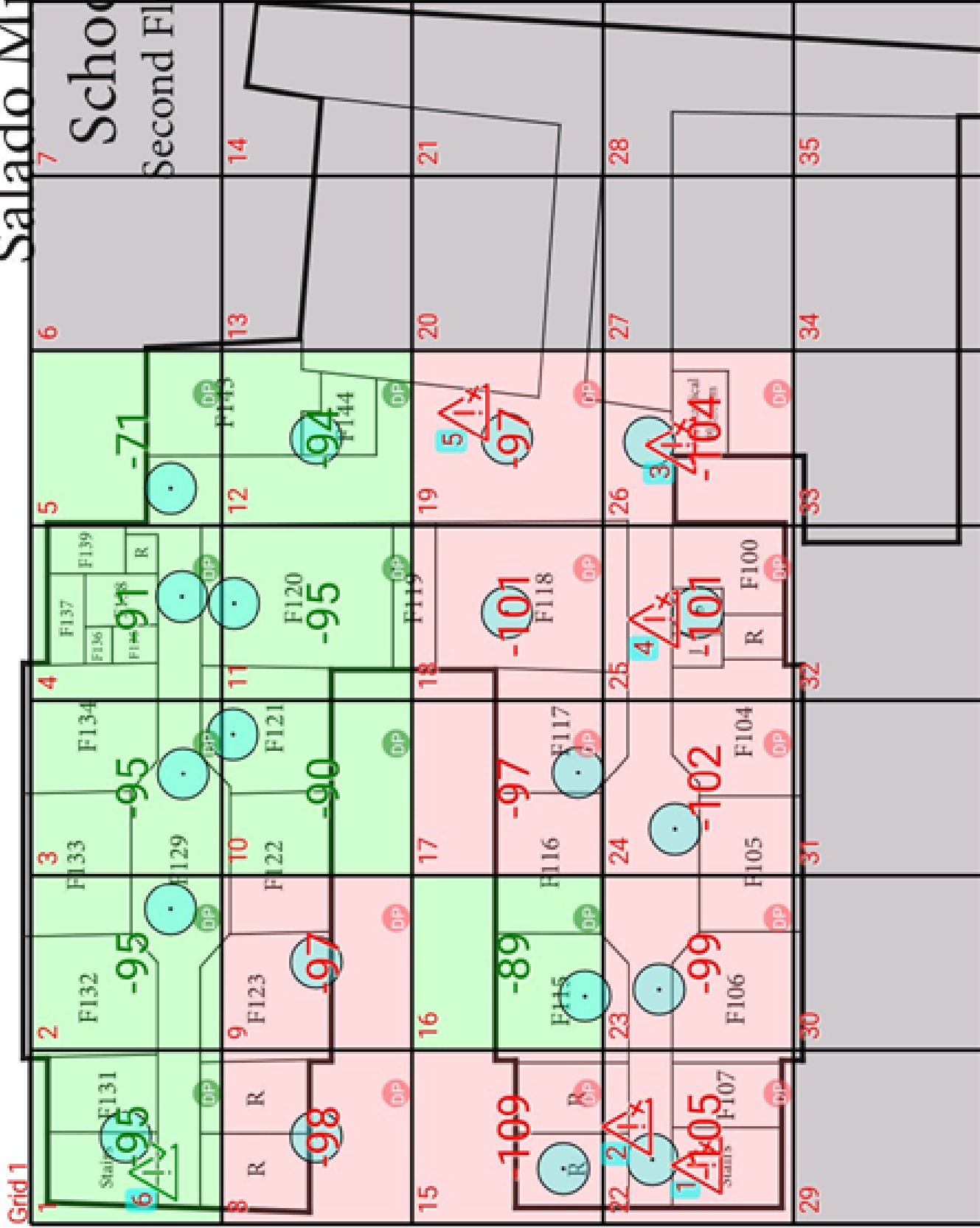

Ch Group	Freq (MHz)	Technology	Band	Result	Area Points passed (%)	Critical Points passed (%)
4	859.23750	P25	Bell County with Troy	Fail	3/44 (6%)	0/2 (0%)

**Test Details**  
 Number of Floors Tested: 1 Result Calculation: By area per floor  
 Number of Areas Tested: 44 Area Pass Criteria: 95%  
 Number of Critical Points Tested: 2 Critical Points Pass Criteria: 99%  
 Apply Adjacent Area Rule: No

Grid	# of Areas	Area Size (sq. ft)	Area Width (ft)	Area Height (ft)	Ignore Area Color	Comments
1	35	300.24	16.59	18.10	Black	

  

Critical Point	DL Power (dBm)	UL Power (dBm)	DL DAQ	UL DAQ	DL Result	UL Result	DL Loss (dB)	UL Loss (dB)	Comment
1	-102.41				Fail				
2	-105.75				Fail				
3	-100.35				Fail				
4	-105.42				Fail				
5	-100.61				Fail				
6	-91.75				Pass				

Grid Area	DL Power (dBm)	UL Power (dBm)	DL DAQ	UL DAQ	DL Result	UL Result	DL Loss (dB)	UL Loss (dB)	Comment
1	-94.34				Pass				
1	-94.73				Pass				
1	-94.10				Pass				
1	-90.88				Pass				
1	-70.94				Pass				
1	NT	NT	NT	NT	NT	NT			
1	NT	NT	NT	NT	NT	NT			
1	-87.95				Fail				
1	-96.20				Fail				
1	-89.50				Pass				
1	-94.82				Pass				
1	-89.41				Pass				
1	NT	NT	NT	NT	NT	NT			
1	NT	NT	NT	NT	NT	NT			
1	-108.25				Fail				
1	-88.21				Pass				
1	-96.01				Fail				
1	-100.79				Fail				
1	-96.96				Fail				
1	NT	NT	NT	NT	NT	NT			
1	NT	NT	NT	NT	NT	NT			
1	-104.93				Fail				
1	-88.25				Fail				
1	-101.61				Fail				
1	-100.86				Fail				
1	-103.76				Fail				
1	NT	NT	NT	NT	NT	NT			
1	NT	NT	NT	NT	NT	NT			
1	NT	NT	NT	NT	NT	NT			
1	NT	NT	NT	NT	NT	NT			
1	NT	NT	NT	NT	NT	NT			
1	NT	NT	NT	NT	NT	NT			
1	NT	NT	NT	NT	NT	NT			
1	NT	NT	NT	NT	NT	NT			
1	NT	NT	NT	NT	NT	NT			
1	NT	NT	NT	NT	NT	NT			
1	NT	NT	NT	NT	NT	NT			
1	NT	NT	NT	NT	NT	NT			
1	NT	NT	NT	NT	NT	NT			
1	NT	NT	NT	NT	NT	NT			

No.	Description	Date
1	DAS SURVEY	05/08/24

<b>SALADO MS - DAS SURVEY RESULTS</b>		
Project number	24-0312	TS-5
Date	06/13/24	
Drawn by	RIG	Author
Checked by		Checker
		Scale
		NTS



**SALADO MIDDLE SCHOOL**

1169 Williams Rd,  
Salado, TX 76571



**TRUENORTH**

13284 Pond Spring Road, Suite 204  
Austin, TX 78729  
ph.512.451.5445 fax.512.451.8777  
www.tnmg.com

Freq (MHz)	Tech	Band	Ant Gain	Cable Loss	Ph. Loss	Type	Mod	MAC	Area Points passed (%)	Critical Point passed (%)
859.23750	P25	Bell County with Troy	0.00	0.00					20/31 (64%)	3/3 (100%)

Test Details	
Number of Floors Tested:	1 Result Calculation: By area per floor
Number of Areas Tested:	40 Area Pass Criteria: 95%
Number of Critical Points Tested:	3 Critical Points Pass Criteria: 99%
	Apply Adjacent Area Rule: No

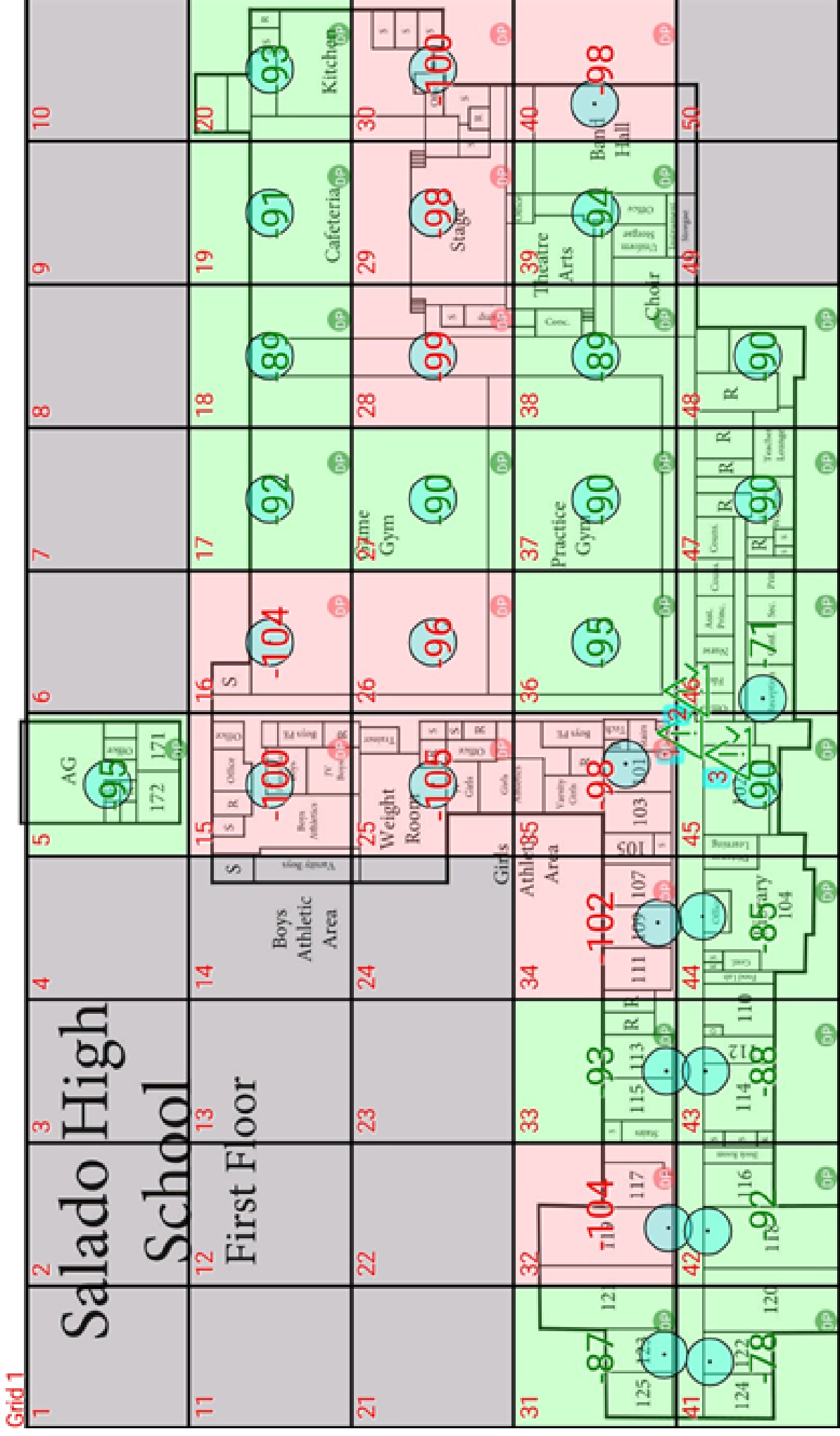

Grid	# of Areas	Area Size (sq. ft)	Area Width (ft)	Area Height (ft)	Ignore Area Color	Comments
1	50	3963.62	59.06	67.11	Black	

Critical Point Report					
Critical Point	DL Power (dBm)	UL Power (dBm)	DL Loss (dB)	UL Loss (dB)	Comment
1	-93.45		Pass		
2	-81.54		Pass		
3	-93.07		Pass		

Area Report					
Critical Point	DL Power (dBm)	UL Power (dBm)	DL Loss (dB)	UL Loss (dB)	Comment
1	-93.45		Pass		
2	-81.54		Pass		
3	-93.07		Pass		

Grid	Area	DL Power (dBm)	UL Power (dBm)	DL Loss (dB)	UL Loss (dB)	Comment
1	1	NT	NT	NT	NT	
1	2	NT	NT	NT	NT	
1	3	NT	NT	NT	NT	
1	4	NT	NT	NT	NT	
1	5	-94.08		Pass		
1	6	NT	NT	NT	NT	
1	7	NT	NT	NT	NT	
1	8	NT	NT	NT	NT	
1	9	NT	NT	NT	NT	
1	10	NT	NT	NT	NT	
1	11	NT	NT	NT	NT	
1	12	NT	NT	NT	NT	
1	13	NT	NT	NT	NT	
1	14	NT	NT	NT	NT	
1	15	-89.29		Fail		
1	16	-103.38		Fail		
1	17	-91.09		Pass		
1	18	-88.86		Pass		
1	19	-90.89		Pass		
1	20	-92.36		Pass		
1	21	NT	NT	NT	NT	
1	22	NT	NT	NT	NT	
1	23	NT	NT	NT	NT	
1	24	NT	NT	NT	NT	
1	25	-104.38		Fail		
1	26	-85.21		Pass		
1	27	-89.85		Pass		
1	28	-98.95		Fail		
1	29	-97.36		Fail		
1	30	-99.20		Fail		
1	31	-86.73		Pass		
1	32	-103.22		Fail		
1	33	-82.89		Pass		
1	34	-101.87		Fail		
1	35	-97.87		Pass		
1	36	-94.03		Pass		
1	37	-89.89		Pass		
1	38	-88.19		Pass		
1	39	-93.30		Pass		
1	40	-97.54		Fail		
1	41	-77.20		Pass		
1	42	-91.89		Pass		
1	43	-87.86		Pass		
1	44	-84.74		Pass		
1	45	-89.85		Pass		
1	46	-70.01		Pass		
1	47	-89.25		Pass		
1	48	-89.54		Pass		
1	49	NT	NT	NT	NT	
1	50	NT	NT	NT	NT	

No.	Description	Date
1	DAS SURVEY	05/08/24

No.	Description	Date
1	DAS SURVEY	05/08/24

**SALADO HIGH SCHOOL**  
 1880 Williams Rd,  
 Salado, TX 76571



**TRUENORTH**  
 13284 Pond Spring Road, Suite 304  
 Austin, TX 78729  
 ph:512.451.5445 fax:512.451.8777  
 www.tmg.com

Project number	24-0312
Date	06/13/24
Drawn by	RIG
Author	
Checked by	Checker
Scale	NTS

**SALADO HS - DAS SURVEY RESULTS**

**TS-6**



# Salado High School Second Floor

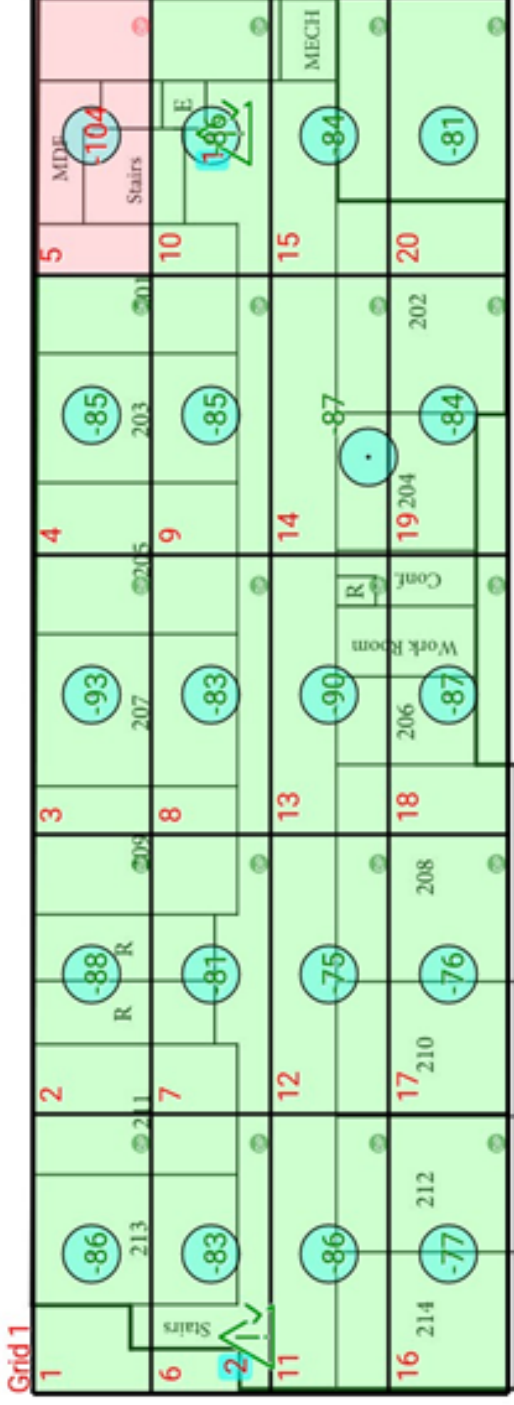

## Test Report Summary

Channel/ Ch Group	Freq (MHz)	Technology	Band	Result	Area Points passed (%)	Critical Points passed (%)
4	859.23750	P25	Bell County with Troy	Pass	19/20 (95%)	2/2 (100%)

### Test Details

Number of Floors Tested: 1  
 Number of Areas Tested: 20  
 Number of Critical Points Tested: 2

Result Calculation:  
 Area Pass Criteria: 95%  
 Critical Points Pass Criteria: 99%  
 Apply Adjacent Area Rule: No

### Equipment Configuration

Vendor	Application	Device	Calibration Expires	Antenna info
PCTEL	SeeHawk Touch rel 3.2.0.2	SeeGull IB flex Device rel 3.8.7.0 SN: 082006011	7-19-2024	

Grid	# of Areas	Area Size (sq. ft)	Area Width (ft)	Area Height (ft)	Ignore Area Color	Comments
1	20	253.68	24.43	10.39	Black	

### Critical Point Report

Critical Point	DL Power (dBm)	DL DAQ	UL Power (dBm)	UL DAQ	Result	DL Loss (dB)	Comment
1	-81.91				Pass		
2	-82.22				Pass		

### Area Report

Grid Area	DL Power (dBm)	DL DAQ	UL Power (dBm)	UL DAQ	Result	DL Loss (dB)	Comment
1 1	-85.77				Pass		
1 2	-87.27				Pass		
1 3	-92.78				Pass		
1 4	-84.54				Pass		
1 5	-103.75				Fail		
1 6	-82.82				Pass		
1 7	-80.41				Pass		
1 8	-82.83				Pass		
1 9	-84.06				Pass		
1 10	-85.24				Pass		
1 11	-85.20				Pass		
1 12	-74.87				Pass		
1 13	-89.83				Pass		
1 14	-86.13				Pass		
1 15	-83.02				Pass		
1 16	-76.89				Pass		
1 17	-75.05				Pass		
1 18	-86.08				Pass		
1 19	-84.00				Pass		
1 20	-80.70				Pass		



No.	Description	Date
1	DAS SURVEY	05/08/24

## SALADO HS - DAS SURVEY RESULTS

Project number	24-0312
Date	06/13/24
Drawn by	RIG Author
Checked by	Checker
Scale	NTS

**TRUENORTH**  
 13284 Pond Spring Road, Suite 304  
 Austin, TX 78729  
 ph: 512.451.5445 fax: 512.451.8777  
 www.trng.com



No.	Description	Date
1	DAS SURVEY	05/08/24

Project number 24-0312  
 Date 06/13/24  
 Drawn by RIG Author  
 Checked by Checker

Scale NTS

TS-8